

Catheter connector guide

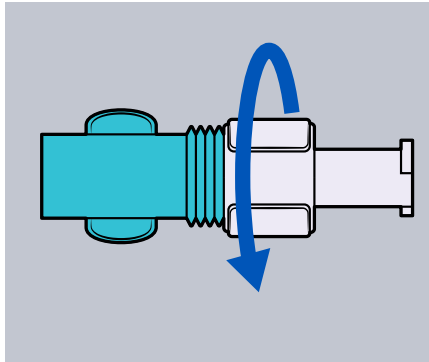

Step 1

Make sure catheter connector is completely unfastened (turn the white dial counter clockwise)

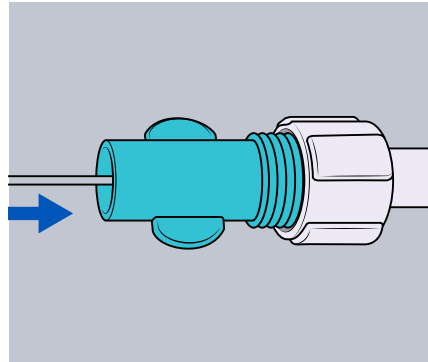

Step 2

Insert the tip of the catheter through the green opening until it cannot be advanced further

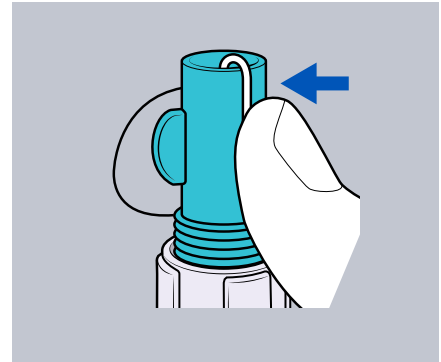

Step 3

Hold catheter in place with your thumb or index finger*

*Holding the catheter in place in this fashion will not affect the integrity of the product

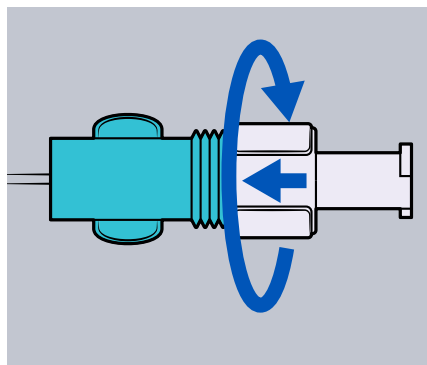

Step 4

While holding the catheter in place, rotate the white connection piece clockwise until the connection is completely tight**

**Fastening the connector tightly will not prohibit meds from being pushed through the catheter

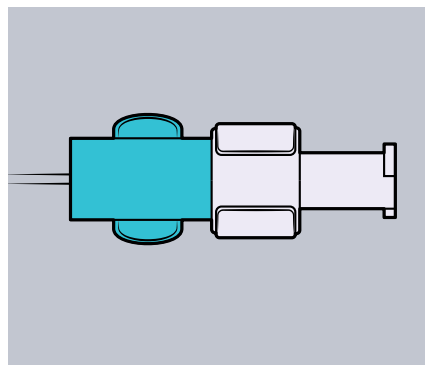

Fully fastened

For questions, contact 800-239-9793 or email productsupportanesthesia@medline.com